

Site reference points colour coding:

RED for 'positive', 'strongly presumed', 'presumed' and 'contaminated' ACMs

BLUE for 'Presumed to contain ACMs due to no access'

GREEN for 'discounted materials', 'no asbestos suspected' and 'negative'

BLACK for 'removed' ACMs

Do not scale, not dimensionally accurate

Note:

This must be reproduced in colour and is to be read in conjunction with the full report.



Annex III Project Ref. 2220AS1157
The Art Surgery, Rear of 1 and 2 Wyndham
Street, Tynwydd, Treorchy.
Ground Floor Plan

Roof space;
2220AS1157 - 004

External – Roof
covering;
2220AS1157 - 005

External – Roof;
2220AS1157 - 006

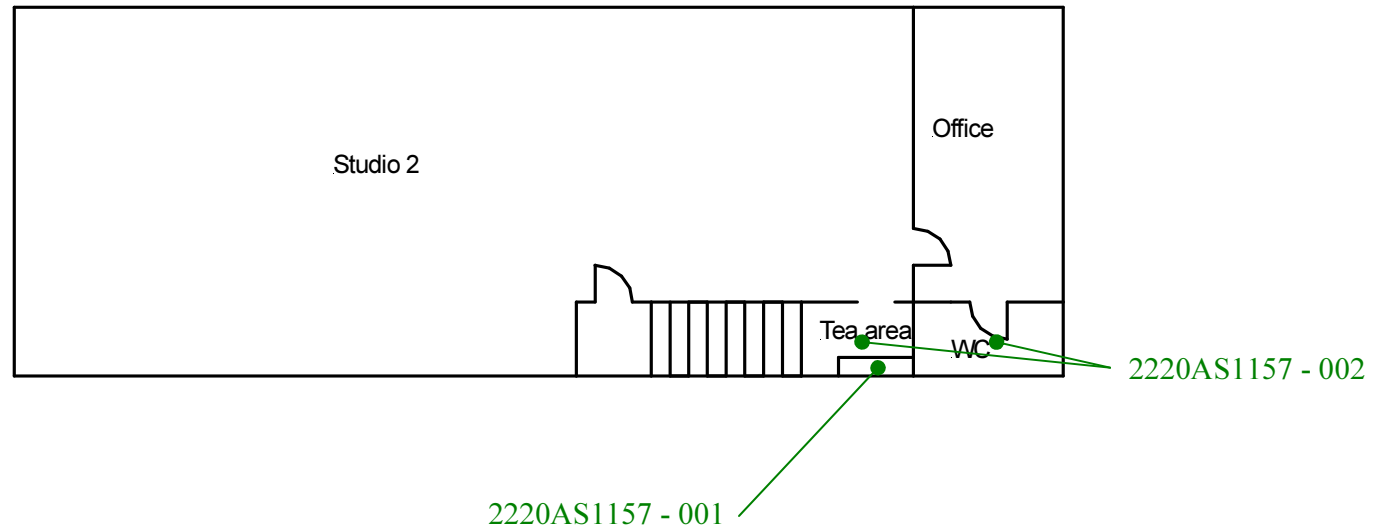

Site reference points colour coding:

RED for 'positive', 'strongly presumed',
'presumed' and 'contaminated' ACMs

BLUE for 'Presumed to contain ACMs due to no
access'

GREEN for 'discounted materials', 'no asbestos
suspected' and 'negative

BLACK for 'removed' ACMs

Do not scale, not dimensionally accurate

Note:

This must be reproduced in colour and is to be read in conjunction
with the full report.



Annex III Project Ref. 2220AS1157
The Art Surgery, Rear of 1 and 2 Wyndham
Street, Tynewydd, Treorchy.
First Floor Plan